

 **REGAL**

Follow no one



Introducing
THE ALL NEW

REGAL 44 SPORT COUPE

REGAL 44

Sport Coupe



After 40 years of boat building, we're still thrilled to introduce new and exciting products every year. This year, we're proud to present the all-new Regal 44 Sport Coupe.

As a company full of boaters – from customer service, to the sales force, to the corner offices – boating runs through our blood. We invite you to closely inspect the 44 Sport Coupe and discover all the details that were built in this boat with your comfort and convenience in mind. For example, we've placed a fresh water hose in the transom locker and another in the anchor locker so there's no need to drag a hose through the cockpit while cleaning. The hard top was designed with an expansive, electric sunroof to put you in control of your boating environment, and we included enough storage to fit all the gear you'll need.

As the current stewards of the Regal brand, we are committed to excellence in boating and understand that owner satisfaction is the single greatest challenge we have. Thank you for considering Regal for your next boat and we look forward to the opportunity to exceed your expectations.

Duane Kuck
President & CEO

Tim Kuck
Executive Vice-President

REGAL ADVANTAGES

■ Convertible Hardtop

The recent trend may be to have an opening sunroof or skylights on an enclosed hardtop, but Regal's never been one to follow trends, only set them. Case in point, the new Regal 44 Sport Coupe's convertible hardtop. The convertible top, which spans the entire beam of the cockpit, electrically slides to reveal a 38-square foot opening. No obtrusive brace to handle or obstruct sight lines.

■ Windshield Walk-Thru

The 44 SC provides the best of both worlds – the comfort and clear sight lines of an enclosed hardtop with the convenience and safety of a windshield walk-thru. Equal parts beauty and function, the windshield walk-thru features Flexiteek inlays and a safety rail.

■ Glass Cockpit Enclosure

Enrich a day on the water with the optional glass cockpit enclosure. The solid partition encloses the forward cockpit seating area without having to set-up canvas. When accompanied by optional Cool Cockpit, passengers are no longer at the mercy of inclement weather.

■ Personalization

The Regal 44 SC allows owners to personalize their express. Multiple selections of countertops, fabric, cabinetry and flooring make each 44 SC as individual as the owners themselves.

■ Pre-Production Price

With a pre-production price beginning at \$489,000, the Regal 44 SC offers a world class 44-express at an unparalleled value.

■ Euro Aft Cockpit Sun Lounge

The 44 SC features the largest sun lounge in its class with the aft Euro cockpit sun lounge. The multi-position backrest will keep four sun bathers relaxed and tan. But true mariners will relish the hands-free storage access below.

■ Single Level Cockpit Sole

The 44 SC's single level cockpit sole provides enhanced sociability as opposed to multi-level cockpits. Guests remain within eye and ear shot of each other regardless of where they sit. All sport yachts entertain, the Regal 44 SC just does it better.

■ Entertainment Upgrades

The 44 SC offers the latest in digital entertainment:

- The master stateroom comes well appointed with a standard 23-inch LCD TV.
- The cockpit can be upgraded with a 26" LCD TV, which electrically lowers from the hardtop.
- The optional DSS satellite TV system allows owners access to favorite HD programs at the dock, under way or in a remote port of call.
- The mid-cabin can be ordered with an optional media center, which includes a 23" LCD TV and DVD player.

REGAL 44

Sport Coupe



Glass Cockpit Enclosure

The glass cockpit enclosure with sliding door and hinged window allows you to open up to the good weather and keep the bad weather out.



Cockpit

The single sole cockpit layout seats up to 14 guests and creates a perfect space for entertaining.

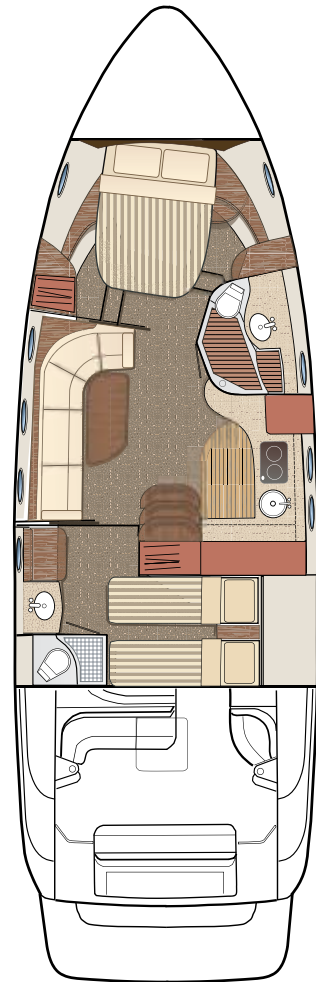

Cabin

The spacious cabin features numerous amenities for your comfort, day or night. The salon boasts ad Ultra Leather fabric, L-shaped sofa and innerspring mattresses are standard forward and aft.

STANDARD EQUIPMENT HIGHLIGHTS

Hull and Deck

- Hardtop – With electric actuated sun roof with bow access from the cockpit
- Hull design – Deep-V OceanTrac for performance and stability
- Hull warranty – Limited lifetime structural
- Single level cockpit sole
- Sunpad – Foredeck; with adjustable chaise lounge

Cockpit Features

- Engine compartment day hatch
- Stereo – Digital AM/ FM/iPod waterproof with 4 speakers and transom controls
- Water system – Pressurized with sink, faucet, hot and cold transom shower
- Wet bar with Corian counter, refrigerator, sink, faucet, and storage

Dash and Helm

- Dash – Increased size to accommodate dual 12" chart plotters
- Electronics – VHF radio, digital depth sounder, chart plotter/GPS
- FlexiTeak- On steps and center walk thru at windshield with stainless safety rail
- Seat – double-wide helm seat with power slide

Salon

- Cabinetry – Hand crafted cherry wood with satin finish
- Dinette – High gloss cherry wood; converts to berth with designated storage
- Home theater system- Bose Lifestyle 321 DVD
- Seating – Ultra Leather fabric, L-shaped sofa with dual recliners
- Wood blinds

Galley

- Appliances – Microwave/convection oven, two-burner range, refrigerator/freezer
- Corian counter top
- Hardwood floor

Forward Stateroom

- Bed – Queen size innerspring mattress with storage below and gas ram actuated lift
- Storage – Hanging lockers, overhead cabinets and bedside shelves

Mid Stateroom

- Armoire – Cedar lined
- Berths – Twin innerspring mattresses convert to queen
- Vanity – Corian top with vessel bowl, faucet, and mirrored cabinet

Forward & Mid-Stateroom Head

- Teak floor
- Shower – Chrome wand with separate controls and teak seat

Windshield

- Windshield – Electrically actuated side vents port and starboard
- Windshield – Fully enclosed front and sides with center walk thru

Technical and Systems

- Air conditioning with reverse cycle heat (26,000 BTU)
- Dockside Power – Single 50 amp/240 volt cord with transformer shore power isolation
- Dockside water inlet
- Generator – gas or diesel
- Vacuum system – Central design
- Volvo IPS Joystick

Volvo Engine Options

- IPS 8.1 GI Gas 500 (standard)
- IPS 500 Diesel
- IPS 600 Diesel

OPTIONAL EQUIPMENT

Aft cockpit enclosure with sliding door and flip up window

Cabinetry – Upgrade to high gloss cherry

Camera monitoring system (requires E-series 120 plotter)

Canvas – Bow sunpad cover

Canvas – Windshield cover

Cockpit table – Forward, high gloss cherry with slider and filler cushion

Cockpit table – Aft, high gloss cherry

Cockpit upholstery upgrade to Ultra Leather

Cool Cockpit

Grill – Electric, in cockpit wet bar

Electric water hose reels (3)

Electric shore power cord reel

Electronics – Closed array radar

Electronics – Open array radar (HD)

Electronics – GPS/Plotter (additional unit)

Electronics – Auto pilot, IPS compatible

Flexi-teak – Swim platform and steps

Flexi-teak – Full cockpit

Gelcoat – Custom (two tone) or premier (full hull)

Granite upgrade – Galley

Granite upgrade – Head (2)

Granite upgrade – Cockpit

Gray water system

Helm seat – Electric, high/low

Icemaker – 110 volt in cockpit, in addition to refrigerator

Salon wood flooring – Maple, cherry or cherry and holly

Lighting package – Blue LED lighting in bow rails and hand rails

Oil change system

Satellite TV – DSS system

Sirius Marine Weather

Stereo: Cockpit performance package includes 2 additional speakers, subwoofer and amplifier

Stereo: Sirius satellite tuner w/antenna (cockpit only)

Stereo: Upgrade to Bose Lifestyle LS35

Swim platform – Hydraulic

Teak Inlay – Full Cockpit

Teak Inlay – Swim platform

TV – Mid-Cabin 23" LCD with DVD

TV – Cockpit 26" LCD with DVD

Toilet – Overboard discharge pump

Underwater lights

Washer/dryer – Stores in mid-cabin armoire

Windshield wiper with washer on portside

REGAL 44

Sport Coupe



Salon

The luxurious salon boasts Ultra-Leather upholstery on the L-shaped sofa, adjustable cherry dinette and the Bose 321 Surround Sound.



Forward Stateroom

Innerspring mattress, abundant storage and easy access make this forward stateroom easy to enjoy.



Aft Stateroom

Standard innerspring mattresses, dedicated head and optional TV will make any guests feel right at home.

SPECIFICATONS

U.S.

METRIC

Overall Length	46'	14.02 m
Beam	14'	4.27 m
Deadrise	20 degrees	20 degrees
Approx. Dry Weight	22,000 lbs	9979 kg
Height – Waterline to Top of Hardtop with Radar	12' 10"	3.91 m
Cockpit Storage	100 ft ³	2.8 m ³
Draft	42"	1.07m
Fuel Capacity	328 gal	1242 L
Fresh Water Capacity	101 gal	382 L
Waste Tank Capacity	48 gal	182 L



Our Mission:

With God's Help and a Steadfast Commitment to Integrity, We will Develop a Team of Exceptional People and Relationships to Provide Exceptional Customer Satisfaction.

Factory Tour

Regal builds sportboats, cruisers & yachts from 19 to 52 feet. When you are in Orlando please stop by to see how beautifully we build them. We are only minutes from the airport and you are cordially invited to be our special guest for a factory tour, Monday – Friday at 9 AM.

Regal Marine Industries, Inc.

World Headquarters
2300 Jetport Drive
Orlando, FL 32809

407-851-4360 • 1-800-U.S.REGAL • fax: 407-857-1256

e-mail: Regal@RegalBoats.com

internet: www.RegalBoats.com